

Type D0

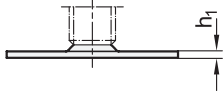

Type D1

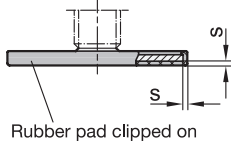

Rubber pad clipped on

Type D3

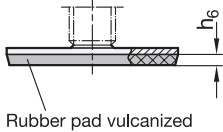

Rubber pad vulcanized

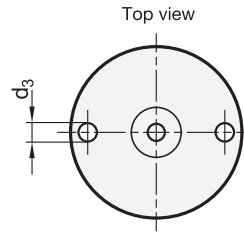

Type B0

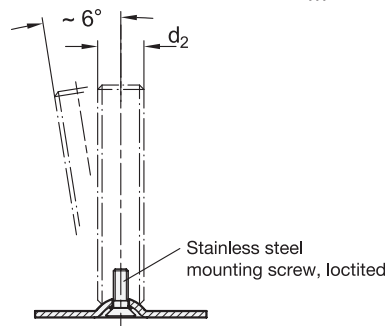
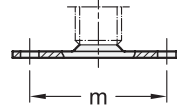

Stainless steel mounting screw, loctited



EDELSTAHL®
Rost
frei
 Inox
 Stainless
 Steel

4 Type (Base plate)

- D0** Without rubber underlay
- B0** Without rubber underlay, with 2 fixing holes
- D1** With rubber underlay, clipped on, black
- D3** With rubber underlay, vulcanized, black

1 **2** **3**

d ₁	d ₂	Version S / SK				Version T / TK						
40	M 8	40	50	63	-	-	-	-	-	-	-	-
40	M 10	50	60	80	100	-	-	-	-	-	-	-
40	M 12	60	80	100	125	-	-	-	-	-	-	-
40*	M 16	-	-	-	-	75	100	125	150	200	250	-
50	M 8	40	50	63	-	-	-	-	-	-	-	-
50	M 10	50	60	80	100	-	-	-	-	-	-	-
50	M 12	60	80	100	125	-	-	-	-	-	-	-
50	M 16	-	-	-	-	75	100	125	150	200	250	-
60	M 8	40	50	63	-	-	-	-	-	-	-	-
60	M 10	50	60	80	100	-	-	-	-	-	-	-
60	M 12	60	80	100	125	-	-	-	-	-	-	-
60	M 16	-	-	-	-	75	100	125	150	200	250	-
80	M 8	40	50	63	-	-	-	-	-	-	-	-
80	M 10	50	60	80	100	-	-	-	-	-	-	-
80	M 12	60	80	100	125	-	-	-	-	-	-	-
80	M 16	-	-	-	-	75	100	125	150	200	250	-
80	M 20	-	-	-	-	75	100	125	150	200	250	-
80	M 24	-	-	-	-	100	125	150	200	300	-	-

* not available in type B0

Versions of threaded stem

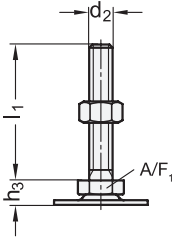

5

S Without nut
SK With nut

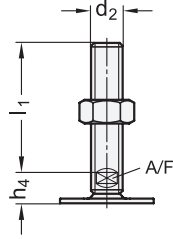

5

T Without nut
TK With nut

External hexagon at the bottom at d_2
M 8, M 10, M 12

Wrench flat at the bottom at d_2
M 16, M 20, M 24

d_1	d_2			d_3	h_1	h_3	h_4	h_6	m	s	A/F_1	A/F_2
40	M 8	M 10	M 12	5,4	2	11	-	3,5	30	1,5	17	-
40	M 16	-	-	5,4	2	-	17	3,5	30	1,5	-	12
50	M 8	M 10	M 12	6,6	2,5	11	-	4	38	2	17	-
50	M 16	-	-	6,6	2,5	-	17	4	38	2	-	12
60	M 8	M 10	M 12	6,6	2,5	11	-	4,5	48	2	17	-
60	M 16	-	-	6,6	2,5	-	17	4,5	48	2	-	12
80	M 8	M 10	M 12	8,5	3	12	-	5	64	2	17	-
80	M 16	-	-	8,5	3	-	18	5	64	2	-	12
80	M 20	-	-	8,5	3	-	19	5	64	2	-	15
80	M 24	-	-	8,5	3	-	22	5	64	2	-	19

Specification

- Base plate
Stainless Steel AISI 316L
Plain, ground
- Threaded stem
Stainless steel AISI 316L
- Hexagon nut ISO 4032
Stainless steel
- Rubber cap
 - Clipped on
 - Black, TPE (Santoprene®)
≈ 80 Shore A
- Rubber underlay
 - Vulcanized
 - Black, NBR (Perbunan®)
70±5 Shore A
- Load Rating Information → Page 2145
- Elastomer Characteristics → Page 2158
- Stainless Steel Characteristics → Page 2166
- RoHS

Information

Stainless steel leveling feet GN 44 are for use in aggressive environments. The range of combinations of base plates and adjustable spindle versions allows these leveling feet to be used in every situation.

The base plate with the rubber underlay protects sensitive surfaces and reduces lateral slippage. The type B0 can also be fastened to the mounting surface through two holes.

The leveling feet are supplied fully assembled and are not removable.

see also...

- Leveling Feet GN 40 (Steel, without Fixing Lug) → Page 1460
- Stainless Steel Leveling Feet GN 41 (without Fixing Lug) → Page 1462
- Leveling Feet GN 42 (Steel, with Fixing Lug) → Page 1466 / 1468
- Stainless Steel Leveling Feet GN 43 (with Fixing Lug)
→ Page 1470 / 1472
- Stainless Steel Leveling Feet GN 45 (with Fixing Lug) → Page 1474

How to order

5 4 3 2 1
GN 44-80-M20-150-D1-T

1	d_1
2	d_2
3	l_1
4	Type (Base)
5	Version (Screw)

